

Hi, just a reminder that you're receiving this email because you have expressed an interest in CAIRE Inc. Don't forget to add taylor.erwin@chartindustries.com to your address book so we'll be sure to land in your inbox.

You may [unsubscribe](#) if you no longer wish to receive our emails.



CAIRE®

A Chart Industries Company

AirSep®  SeQual®

www.CAIREmedical.com

Med Tips

In This Issue

[Helpful Hints / FAQs](#)
[Service Schools &
Tradeshows](#)
[Contact Us](#)

PDF Version

To view Med Tips in PDF,
[click here.](#)

Join Our List

[Join Our Mailing List!](#)

March 2014

PRODUCT INFORMATION

Pulse Dose Mode Explained for SeQual Eclipse™ Units

Q: What is the correlation between the Pulse Flow Settings and the Continuous Flow Settings of the SeQual Eclipse™?

A: There is no direct correlation between these two settings.

Pulse Dose mode on the Eclipse is a mode in which the user draws a breath of air, when the vacuum (negative pressure) is sensed by the Eclipse unit, the device releases oxygen at a high flow rate for a short duration of time to the O2 cannula port. The Pulse Flow Setting determines the Bolus size. The benefit of using Pulse Dose mode is increased battery duration while providing prescribed oxygen therapy. As for Continuous Flow, this is flow at a constant rate, with no "pulsing".

Calculation: $Bolus\ Volume\ (mL) = Pulse\ Peak\ Flow\ (LPM) \times Pulse\ Duration\ (ms) \div 60$ (to get correct units)

Flow Setting	Pulse Peak Flow, LPM (volumetric)	Pulse Duration (milli-second)	Bolus Volume (ml)
1	8	120	16
2	9	213	32
3	10	288	48
4	11	349	64
5	12	400	80
6	13	443	96
128	15	512	128
160	17	565	160
192	19	606	192

Table for Fast Rise Time Settings
(factory default is Fast, BOL=FAST)

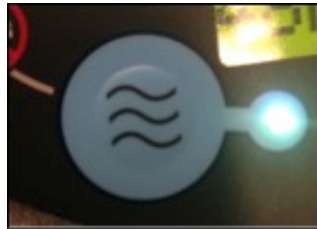

The Eclipse LED illuminated when a pulse dose is delivered.

For Example: Patient is using a Pulse setting of 4.0.
The Pulse Peak Flow would be 11LPM; Pulse Duration would be 349ms.

$$\text{Bolus Volume (mL)} = 11 \times 349 \div 60 = \underline{64 \text{ mL}}$$

Note: For Eclipse models preceding the Eclipse 5, the lower pulse settings were displayed as Pulse Flow Settings instead of bolus volume values.

Acoustic Foam on Panels of NewLife® Units

The acoustic foam on the inside panels of the NewLife Elite, Intensity, and Intensity 10 can be ordered as follows:

- Foam on Side Panels: **F0101-1**
- Foam on Front Panels: **F0008-1**

QDV Metal Poppets on CAIRE Reservoirs and Portables

As a reminder, the QDV design for HELiOS and Companion portables and reservoirs changed around June 1st, 2012. The change was from a plastic poppet design to an improved and more robust stainless steel poppet design. Please [click here](#) to view the service bulletin for the reservoir QDV poppet change and [click here](#) to view the service bulletin for the portable poppet change.

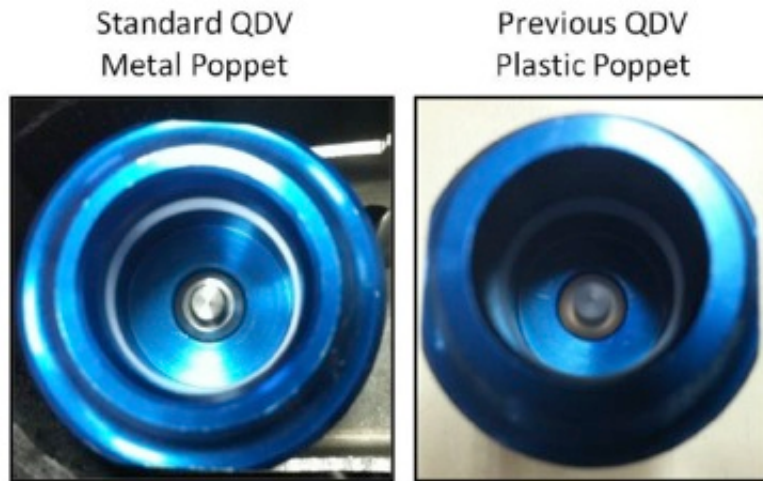

It is also important to note that during this time, QDVs were changed on the transfill adapters/lines as well. If the transfill adapter has a previous style lip seal (pictured below on left), then a previous-style lip seal will be needed to be ordered if the lip seal is going to be replaced. If a new QDV is to be ordered, and installed on the existing transfill line adapter, it will use the current-style lip seal (pictured below on right). Please note that the lip seals are not interchangeable.



Previous Style
QDV Lip Seal
PN: B-775262-00

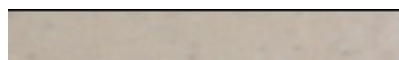



Current Style
QDV Lip Seal
PN: CA110104

Integra Compressor Intake Filter - Incorporation of Velcro Strip

Effective immediately, the SeQual Integra's Compressor Intake Filter (PN: SP4405-SEQ) will include a Velcro strip to better attach the filter to the unit. This design improvement was made to account for the slight difference in mating of the filter to the muffler assembly. Please [click here](#) to view the Service Bulletin for the incorporation of the Velcro strip with the compressor intake filter.



HELPFUL HINTS / FAQs

Installing the Eclipse Power Cartridge Face Plate

Step 1. Remove screws by rotating counter-clockwise using #2 Phillips head screwdriver.



Step 2. Turn power cartridge 180° from above position to position shown below. Pull up on face plate.



Step 3. Pull face plate away from power cartridge.

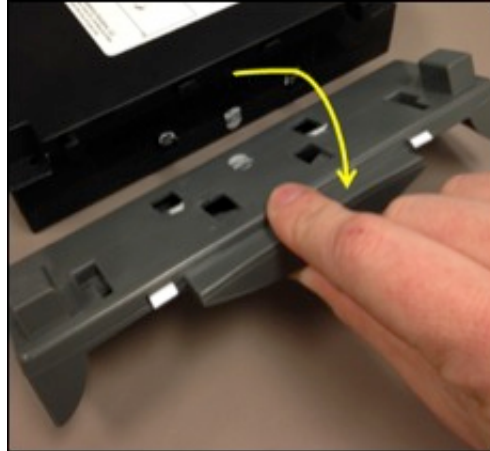

Step 4. Place new face plate onto alignment tabs of power cartridge.

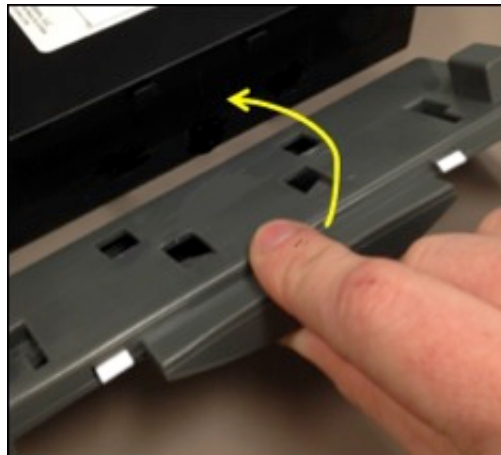

Step 5. Push down on face plate until face plate is seated on power cartridge.







Step 6. Reinstall screws by rotating clockwise. Tighten until screws seat down, careful not to exceed 6 in-lbs.

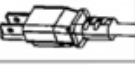

ACCESSORIES

AC and DC Power Supply PN Table for AirSep POCs

The below table can be used to order AC and DC power supplies for the AirSep POCs.

POC Model (Nominal Voltages / Frequencies)	AirBelt PN:	AC Power Supply:	DC Power Supply:	AC Power Cord:	
US-Style Power Cord (120V / 60Hz)					
Focus - US	BT017-1*	PW023-1**		AC Power Cord that Goes from Brick to Wall	
FreeStyle - US	BT017-1		PW022-1	Receptacle can be Ordered using PN: CD023-2	
FreeStyle 5 - US		PW021-1	PW027-1		
European-Style Power Cord (220V / 50Hz)					
Focus - European	BT017-2*	PW023-2**		AC Power Cord that Goes from Brick to Wall	
FreeStyle - European	BT017-2		PW022-2	Receptacle can be Ordered using PN: CD017-2	
FreeStyle 5 - European		PW021-2	PW027-1		
Australian-Style Power Cord (240V / 50Hz)					
Focus - Australian	BT017-3*	PW023-3**		AC Power Cord that Goes from Brick to Wall	
FreeStyle - Australian	BT017-3		PW022-3	Receptacle can be Ordered using PN: CD025-1	
FreeStyle 5 - Australian		PW021-3	PW027-1		
UK-Style Power Cord (230V / 50Hz)					
Focus - UK	BT017-4*	PW023-4**		AC Power Cord that Goes from Brick to Wall	
FreeStyle - UK	BT017-4		PW022-4	Receptacle can be Ordered using PN: CD017-4	
FreeStyle 5 - UK		PW021-4	PW027-1		

*Will also need Focus Cable Adapter, PN: CD035-1, to connect to AirBelt
 **Will need to order Coil Cord to Battery, PN: CD032-2, if option to charge battery is desired.

SeQual Eclipse Power Cartridge and Face Plate

The Eclipse Power Cartridge (battery) can be ordered using part number **7082-SEQ**. The power cartridge is compatible with all Eclipse models.

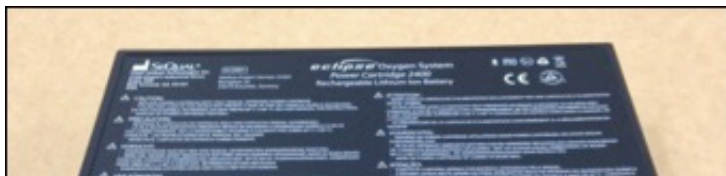



Eclipse Power Cartridge: PN 7082-SEQ

The face plate of the Eclipse power cartridge can be ordered using PN 4556-1-SEQ and has the same color as the Eclipse 5 units. This part can be ordered if the locking tabs are broken from an existing power cartridge.

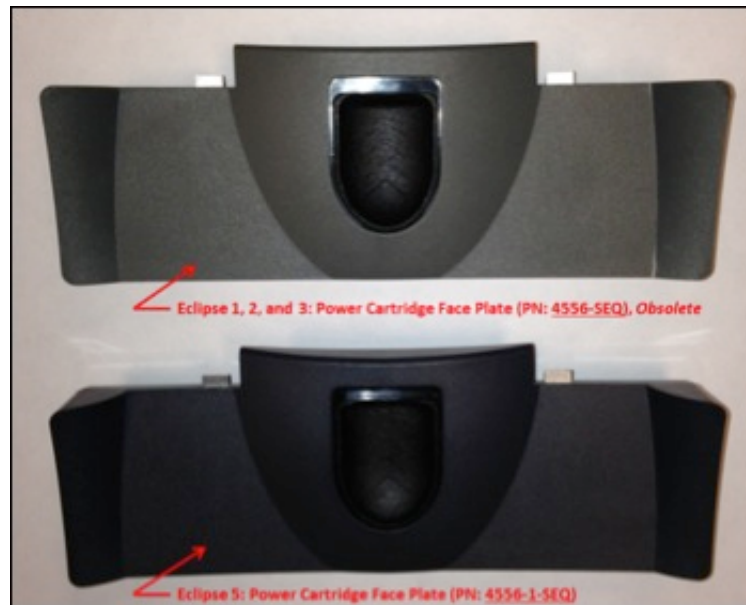

Aesthetic Difference Between Old Style Face Plate and New Style Face Plate

The power cartridge's face plate will be the color of the Eclipse 5 units. If used in an earlier model Eclipse, it will still function properly and will only be a slightly different color, as shown below.



Eclipse Power Cartridge with Eclipse 5 Face

Eclipse Tower Cartridge with Eclipse 3 Face
Plate Used in Earlier Model Eclipse

SERVICE SCHOOLS & TRADESHOWS

Mark Your Calendars for our Upcoming 2014 Service Schools!

USA

2014 Service School dates have been released!

For additional details and registration information about these trainings, please visit the ["Events & Service Schools"](#) tab of our website.

Concentrator Training: March 3, 4, 5 in Denver, CO

LOX Training: March 6 & 7 in Denver, CO

Concentrator Training: June 9, 10, 11 in Ball Ground, GA

LOX Training: June 12 & 13 in Ball Ground, GA

**Ball Ground trainings include a tour of our CAIRE and SeQual manufacturing facility.*

Concentrator Training: August 18, 19, 20 in Buffalo, NY

LOX Training: August 21 & 22 in Buffalo, NY

**Buffalo trainings include a tour of our AirSep manufacturing facility.*

Concentrator Training: November 10, 11, 12 in Ball Ground, GA

LOX Training: November 13 & 14 in Ball Ground, GA

**Ball Ground trainings include a tour of our CAIRE and SeQual manufacturing facility.*

Europe

2014 Service School dates have been released!

For additional details and registration information about these trainings, please visit the ["Events & Service Schools"](#) tab of our website.

German Concentrator Training: March 4, 5, 6 in Wuppertal Germany

German LOX Training: March 18 & 19 in Wuppertal Germany

U.S. LOX Training: March 18 & 19 in Wuppertal Germany

Italian LOX Training: March 26 & 27 in Padova, Italy

English LOX Training: April 15 & 16 in Wuppertal, Germany

English Concentrator Training: May 20, 21, 22 in Wuppertal Germany

French LOX Training: June 2 & 3 in France

French Concentrator Training: June 4, 5, 6 in France

Italian Concentrator Training: June 10, 11, 12 in Padova, Italy

Spanish LOX Training: June 16 & 17 in Barcelona, Spain

Spanish Concentrator Training: June 18, 19, 20 in Barcelona, Spain

German LOX Training: September 9 & 10 in Wuppertal, Germany

German Concentrator Training: October 14, 15, 16 in Wuppertal, Germany

English LOX Training: October 28 & 29 in Wokingham, UK

Italian LOX Training: October 29 & 30 in Padova, Italy

English Concentrator Training: November 18, 19, 20 in Wokingham, UK

Tradeshows

We will be attending the following trade shows this month. We would love for you to stop by our booth!

Medtrade Spring

March 11-12
Las Vegas, NV
CAIRE
Booth #521

DGP

March 26-29
Bremen
Stand #63
CAIRE

NYMEP Annual Meeting

March 31- April 1

White Plains, NY

CAIRE Booth

CONTACT US

For ordering information, contact Customer Service:

United Kingdom	+44 (0) 1189 367060
France	+33 (0) 561 429 411
Germany	+49 (0) 202 739 55420
Italy	+39 049 879 9601
	customerservice.europe@chartindustries.com
Australia/New Zealand	+61 2 9749 4333
Asia/Pac Rim	customerservice.australia@chartindustries.com
	770.721.7759
	csasia@chartindustries.com
The Americas	770.721.7759
US Toll-Free	800.482.2473
	customerservice.usa@chartindustries.com

For technical information, contact Technical Service:

United Kingdom	+44 (0) 1189 367060
France	+33 (0) 561 429 411
Germany	+49 (0) 202 739 55420
Italy	+39 049 879 9160
	techservice.europe@chartindustries.com
Asia/Pac Rim	+61 2 9749 4333
	techservice.asia@chartindustries.com
The Americas	770.721.7759
	techservice.usa@chartindustries.com
US Toll-Free	800.482.2473
	techservice.usa@chartindustries.com

[Forward email](#)



Try it FREE today.

This email was sent to snystrom@sequal.com by taylor.erwin@chartindustries.com | [Update Profile/Email Address](#) | Instant removal with [SafeUnsubscribe™](#) | [Privacy Policy](#).

Chart Industries | 2200 Airport Industrial Dr. | Ste. 500 | Ball Ground | GA | 30107