

COMPANION RESERVOIR FCV EXTENSION / HUMIDIFIER ADAPTER

The Companion Flow Control Valve extension "Humidifier adaptor" is P/N B-775314-00. This piece is shown below as item 22 in the diagram.

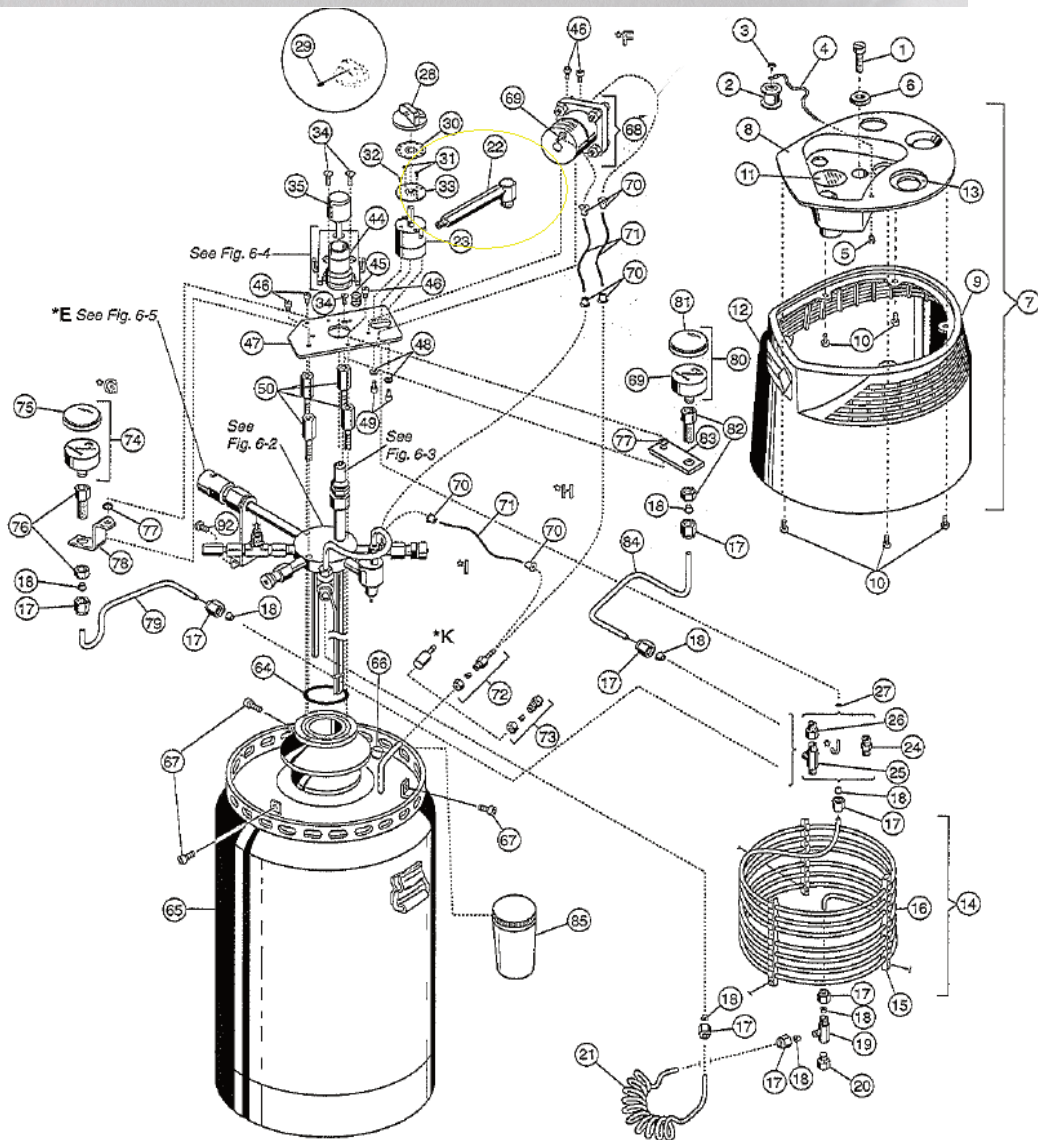

CR-50 CONSERVER CHANGES

The CR-50 Conserver will no longer be available with a CGA 540 connection, shown in Figure 2 below. However, the CR-50 will still be offered with a CGA 870 connection, shown in Figure 1, and may be purchased using PN 6-134220-01.

Figure 1: CR-50 w/ CGA 870, PN 6-134220-01

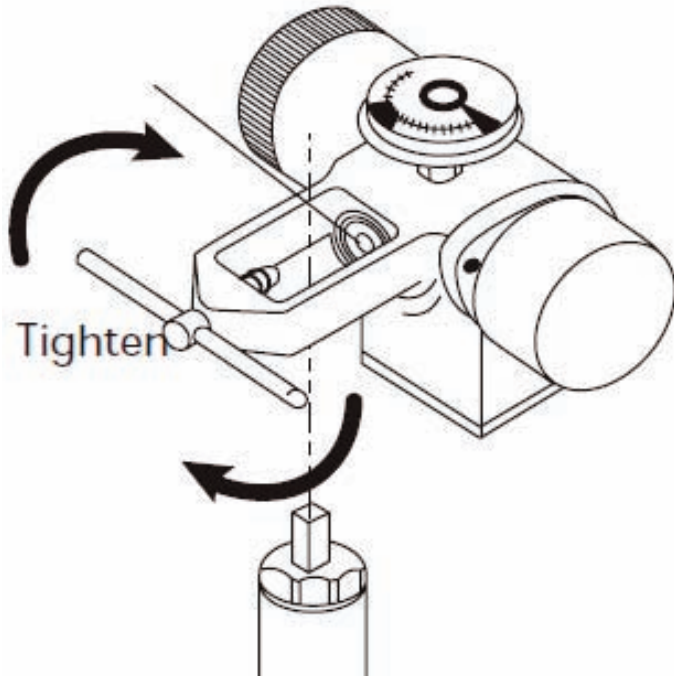
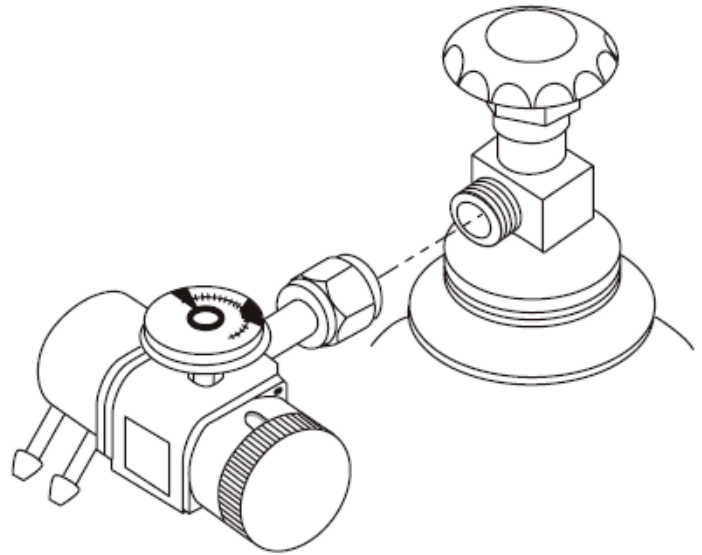

Figure 2: No Longer Available



PEDIATRIC FCV 0-2LPM UPDATE

If a Pediatric FCV is ordered it doesn't come with the decal and this needs to be ordered separate as the old one is incompatible.

	Old Obsolete PN's	New PN's to Order From
Base FCV	11818203T	14700243T
Base Decal	13758873	14700438
Portable FCV	11923417T	14700235T
Portable Decal	13938639	14700411

Customer & Technical Info

For ordering information contact

Customer Service:

Europe: +44 1344 403100
Australia/New Zealand: +61 2 9749 4333
US Toll Free: 800.482.2473
Asia/Pac Rim: 770.721.7759
The Americas: 770.721.7759

For technical information contact

Technical Service:

Europe:
 Phone: +441344 403100
 Email: technicalservice.europe@chart-ind.com
US Toll Free
 Phone: 800.482.2473
 Email: techservice.usa@chart-ind.com
Asia/Pac Rim
 Phone: 770.721.7759
 Email: techservice.usa@chart-ind.com